

Compression fittings (series KRV)

Indication of use:

Max. working temperature: 400°C (steel clamp ring), 250°C (PTFE) in each case not at max. pressure!  
 Max. pressure: 250 bar (steel clamp ring), 6 bar (PTFE) in each case not at max. temperature!  
 ±-tolerance MI-cable: +/-0,05mm

Screwed fixed base; take care of scratch free counter seal surface in screwing and assembly area.  
 Without proper counter seal surfaces: Tight the body with copper ring 11x8,2,0,8 or Teflon tape on the thread. Consider the temperature limits of the tools!  
 Tightening the nut when mounting the sensor / MI cable: First by hand, after in addition with wrench 1½ turns.

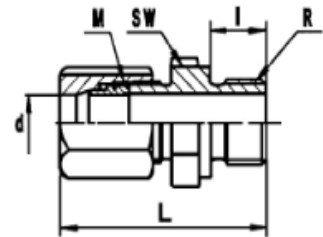

Compression fittings for MI cable

MI-cable Ø [mm]	Part lengths-L [mm]	Width across flats SW	Thread-R- at body	Order code	
				Clamp ring stainless steel	Seal ring PTFE
0,5	24,0	12	M8x1	-	KRV-M8x1-0,5-T
1,0	24,0	12	M8x1	KRV-M8x1-1,0	KRV-M8x1-1,0-T
1,5	24,0	12	M8x1	KRV-M8x1-1,5	KRV-M8x1-1,5-T
2,0	25,0	12	M8x1	KRV-M8x1-2,0	KRV-M8x1-2,0-T
2,5	25,0	12	M8x1	KRV-M8x1-2,5	KRV-M8x1-2,5-T
3,0	26,0	12	M8x1	KRV-M8x1-3,0	KRV-M8x1-3,0-T
3,0	36,0	17	M12x1,5	KRV-M12x1,5-3,0	KRV-M12x1,5-3,0-T
2,0	25	13	M8x1	KRV-M8x1-2,0-SW13	KRV-M8x1-2,0-SW13-T
2,5	25	13	M8x1	KRV-M8x1-2,5-SW13	KRV-M8x1-2,5-SW13-T
3,0	26	13	M8x1	KRV-M8x1-3,0-SW13	KRV-M8x1-3,0-SW13-T
2,0	24,0	14	G1/8"	KRV-G1/8-2,0	KRV-G1/8-2,0-T
3,0	25,0	14	G1/8"	KRV-G1/8-3,0	KRV-G1/8-3,0-T

Further diameter and threads on request!

Spare part clamp rings for compression fittings



Ø [mm]	Order code	
	Stainless steel AISI 316Ti	PTFE
0,5	-	KR-T-0,5
1,0	KR-S-1,0	KR-T-1,0
1,5	KR-S-1,5	KR-T-1,5
2,0	KR-S-2,0	KR-T-2,0
2,5	KR-S-2,5	KR-T-2,5
3,0	KR-S-3,0	KR-T-3,0

Further diameter on request!